

Table of Contents	1
Addendum #2 Letter	2
Addendum #2 Revised Plan Sheets	3



State of Vermont
Contract Administration
Barre City Place
219 North Main Street, Suite 105
Barre VT 05641
<http://vtrans.vermont.gov>

*Agency of Transportation
Finance & Administration*
[phone] 802-622-1285
[ttd] 800-253-0191

June 9, 2026

Co3273 – Weston ER P23-1(230)

ADDENDUM #2

Bidders:

Changes have been made to the documents located on the Bid Opportunity website as noted below:

REVISED: Plan Sheets 2 and 27.

ADDED: None.

DELETED: None.

VTrans Mission and Vision

Through excellent customer service, provide for the safe and efficient movement of people and goods.
A safe, reliable, and multimodal transportation system that grows the economy, is affordable to use and operate, and serves vulnerable populations.



PRELIMINARY INFORMATION SHEET (CULVERT)

INDEX OF SHEETS

PLAN SHEETS

1	TITLE SHEET
2	PRELIMINARY INFORMATION SHEET
3 - 4	TYPICAL SECTIONS 1-2
5	PROJECT NOTES
6 - 7	QUANTITY SHEETS 1-2
8	CONVENTIONAL SYMBOLOGY LEGEND
9	TIE SHEET
10	ALIGNMENT DATA
11	EXISTING CONDITIONS
12	LAYOUT
13	GRADING PLAN
14	ROADWAY PROFILE
15	CHANNEL PROFILE
16 - 18	SUGGESTED STAGING PLAN 1-3
19 - 20	CULVERT STAGING SECTIONS 1-2
21	TRAFFIC CONTROL NOTES AND DETAILS
22	TRAFFIC CONTROL DETOUR PLAN
23	BORING LAYOUT SHEET
24 - 25	BORING LOGS 1-2
26	PLAN AND ELEVATION
27	CULVERT DETAILS
28	WINGWALL AND HEADWALL
29	MOMENT SLAB
30 - 32	ROADWAY CROSS SECTION 1-3
33 - 36	CHANNEL CROSS SECTION 1-4
37	LANDSCAPE PLANTING PLAN
38	EPSC DETAILS
39	R.O.W. DETAIL SHEET
40	R.O.W. LAYOUT SHEET

STANDARDS LIST

D-4	VARIOUS DRAINAGE DETAILS	08-13-2007
E-2	SHRUB PLANTING	06-25-2024
E-10	ROLLED EROSION CONTROL PRODUCT, TYPE I	04-07-2020
E-12	STABILIZED CONSTRUCTION ENTRANCE	04-07-2020
E-15	SILT FENCE	04-07-2020
F-2	CHAIN LINK FENCE, TYPE I DETAILS	06-01-1994
G-1	STEEL BEAM GUARDRAIL DETAILS (POST, DELINEATOR, TYPICALS)	06-24-2025
G-10	STEEL BEAM GUARDRAIL DETAILS (END TERMINAL, ANCHOR, MEDIUM)	06-24-2025
G-19	GENERIC GRADING PLANS FOR GUARDRAIL END TERMINALS	10-02-2018
S-501	CONCRETE DETAILS AND NOTES	02-15-2023
T-1	TRAFFIC CONTROL GENERAL NOTES	06-24-2025
T-2	TRAFFIC SIGN GENERAL NOTES	06-24-2025
T-10	CONVENTIONAL ROADS CONSTRUCTION APPROACH SIGNING	06-24-2025
T-13	TRAFFIC CONTROL DIVIDED HIGHWAY ONE LANE CLOSED	06-25-2025
T-30	CONSTRUCTION SIGN DETAILS	02-17-2022
T-31	CONSTRUCTION SIGN DETAILS	06-24-2025
T-35	CONSTRUCTION ZONE LONGITUDINAL DROP-OFFS	06-24-2025
T-36	CONSTRUCTION ZONE LONGITUDINAL DROP-OFFS FOR PAVING	06-24-2025
T-40	DELINEATORS AND MILEPOSTS	06-24-2025
T-42	BRIDGE NUMBER PLAQUE	06-24-2025
T-44	MILEMARKER DETAILS STATE AND TOWN HIGHWAYS	06-24-2025
T-45	SQUARE TUBE SIGN POST AND ANCHOR	06-24-2025
T-56	STANDARD SIGN PLACEMENT	06-24-2025
T-193	PAVEMENT MARKING DETAILS	06-24-2025

DETAIL SHEETS

HSD-621.07A	MIDWEST GUARDRAIL SYSTEM (MGS)	1/4/2021
HSD-621.07B	W-BEAM GUARDRAIL COMPONENTS	4/17/2019
HSD-621.07C	MIDWEST GUARDRAIL SYSTEM (MGS) ANCHOR	4/17/2019
HSD-621.07D	MIDWEST GUARDRAIL SYSTEM (MGS) ANCHOR COMPONENTS	4/17/2019
HSD-621.07E	MIDWEST GUARDRAIL SYSTEM (MGS) ANCHOR COMPONENTS	4/17/2019
HSD-621.07F	MIDWEST GUARDRAIL SYSTEM TRANSITION SECTION	1/4/2021

ADDENDUM	REVISION	DATE	DESCRIPTION	BY
	1	06-09-2026	ADDED UNITS FOR FLOW FREQUENCY	CSB

FINAL HYDRAULIC REPORT

DATE: 2/19/2025

TOWN: Weston COUNTY: Windsor
 PROJECT NO.: ER P23-1(230)
 HIGHWAY NO.: VT-100 STRUCTURE NO.: 93
 STREAM: unnamed trib

STRUCTURE AND CHANNEL INFORMATION:

DRAINAGE AREA: 1.21 SQ. MI.
 DESIGN FLOW FREQUENCY: 2% AEP (Q50)

STRUCTURE SPAN: 16-FT
 STRUCTURE HEIGHT: 8-FT
 STRUCTURE EMBEDMENT: 2-FT
 STRUCTURE INFILL MATERIAL: E-STONE FILL, TYPE II
 STRUCTURE WATERWAY AREA: 96 SF

STRUCTURE INLET INVERT ELEVATION: 1288.01-FT
 STRUCTURE OUTLET INVERT ELEVATION: 1281.52-FT
 STRUCTURE LENGTH: 140-FT

FLOW FREQUENCY:	FLOW:	HEADWATER ELEVATION:	OUTLET VELOCITY:
AEP 50% (Q2):	76 CFS	1291.09-FT	8.5-FPS
AEP 10% (Q10):	170 CFS	1291.73-FT	10.4-FPS
AEP 4% (Q25):	230 CFS	1292.06-FT	11.2-FPS
AEP 2% (Q50):	290 CFS	1292.37-FT	12.0-FPS
AEP 1% (Q100):	350 CFS	1292.65-FT	12.7-FPS



TAILWATER ELEVATION @ DESIGN FLOW: 1283.01-FT
 ROADWAY OVERTOPPING FREQUENCY: N/A
 DISCHARGE OVER ROAD @ Q100: N/A

REQUIRED CHANNEL BANK PROTECTION: STONE FILL TYPE III

COMPLETED BY: MHG
 REVIEWED BY: JAD

TRAFFIC MAINTENANCE NOTES

- STAGE 1 MAINTAIN TRAFFIC ON AN OFF SITE DETOUR.
- STAGE 1 TRAFFIC SIGNALS ARE NOT NECESSARY.
- STAGE 2 & 3 MAINTAIN ONE-WAY TRAFFIC ON THE EXISTING STRUCTURE.
- STAGE 2 & 3 INSTALL AND MAINTAIN TRAFFIC SIGNALS.
- SIDEWALKS ARE NOT NECESSARY.

DESIGN VALUES

1. DESIGN LIVE LOAD	HL-93
2. FUTURE PAVEMENT	d_p : 3.0 INCH
3. CULVERT OPENING	D : 16.00 FT
4. MIN. MID-SPAN POS. CAMBER @ RELEASE (PRESTRESSED UNITS)	Δ : ---
5. PRESTRESSING STRAND	f_y : ---
6. PRESTRESSED CONCRETE STRENGTH	f'_c : ---
7. PRESTRESSED CONCRETE RELEASE STRENGTH	f'_{ci} : ---
8. HIGH PERFORMANCE CONCRETE, CLASS PCD	f'_c : ---
9. HIGH PERFORMANCE CONCRETE, CLASS PCS	f'_c : ---
10. CONCRETE HIGH PERFORMANCE, CLASS SCC	f'_c : ---
11. CONCRETE, CLASS C	f'_c : ---
12. REINFORCING STEEL	f_y : 60 KSI
13. STRUCTURAL STEEL AASHTO M270	f_y : ---
14. NOMINAL BEARING RESISTANCE OF SOIL	q_n : ---
15. SOIL BEARING RESISTANCE FACTOR (REFER TO AASHTO LRFD)	ϕ : ---
16. NOMINAL BEARING RESISTANCE OF ROCK	q_n : ---
17. ROCK BEARING RESISTANCE FACTOR (REFER TO AASHTO LRFD)	ϕ : ---
18. PILE RESISTANCE FACTOR	ϕ : ---
19. LATERAL PILE DEFLECTION	Δ : ---
20. BASIC WIND SPEED	V_{3s} : ---
21. MINIMUM GROUND SNOW LOAD	pg : ---
22. SEISMIC DATA	PGA : --- S_s : --- S_1 : ---
23.	---
24.	---
25.	---
26.	---

LRFR LOAD RATING FACTORS

LOADING LEVELS	TRUCK						
	H-20	HL-93	3S2	6 AXLE	3A STR.	4A STR.	5A SEM
TONNAGE	20	36	36	66	30	34.5	38
INVENTORY							
POSTING							
OPERATING							

COMMENTS: TABLE TO BE COMPLETED BY CONTRACTOR'S DESIGNER

CULVERT DESIGN CRITERIA

- PROPOSED CULVERT IS A PRECAST CONCRETE STRUCTURE (16'-0" X 8'-0" X 140'-0" BOX).
- CULVERT ENDS ARE NOT SKEWED.
- CULVERT WILL BE SET AT A SLOPE OF 0.54 IN. ON 1 FT.
- CULVERT WILL NOT REQUIRE FISH PASSAGE ACCOMMODATIONS
- CULVERT CONSTRUCTION WILL NOT REQUIRE A TEMPORARY PIPE

TRAFFIC DATA

YEAR	ADT	DHV	% D	% T	ADTT	20 year ESAL for flexible pavement from 2026 to 2046 : 1133000
2026	3001	466	51	3.2	206	40 year ESAL for flexible pavement from 2026 to 2066 : 2607000
2046	3246	504	51	4.9	349	Design Speed : 50 mph

AS BUILT "REBAR" DETAIL

LEVEL I	LEVEL II	LEVEL III
TYPE:	TYPE:	TYPE:
GRADE:	GRADE:	GRADE:

PROJECT NAME: WESTON

PROJECT NUMBER: ER P23-1(230)

FILE NAME: z24b003forms.dgn

PROJECT LEADER: A.SPERA

DESIGNED BY: C.BURNER

PRELIMINARY INFORMATION SHEET

PLOT DATE: 10/23/2025

DRAWN BY: C.BURNER

CHECKED BY: L.CECCHI

SHEET 2 OF 40

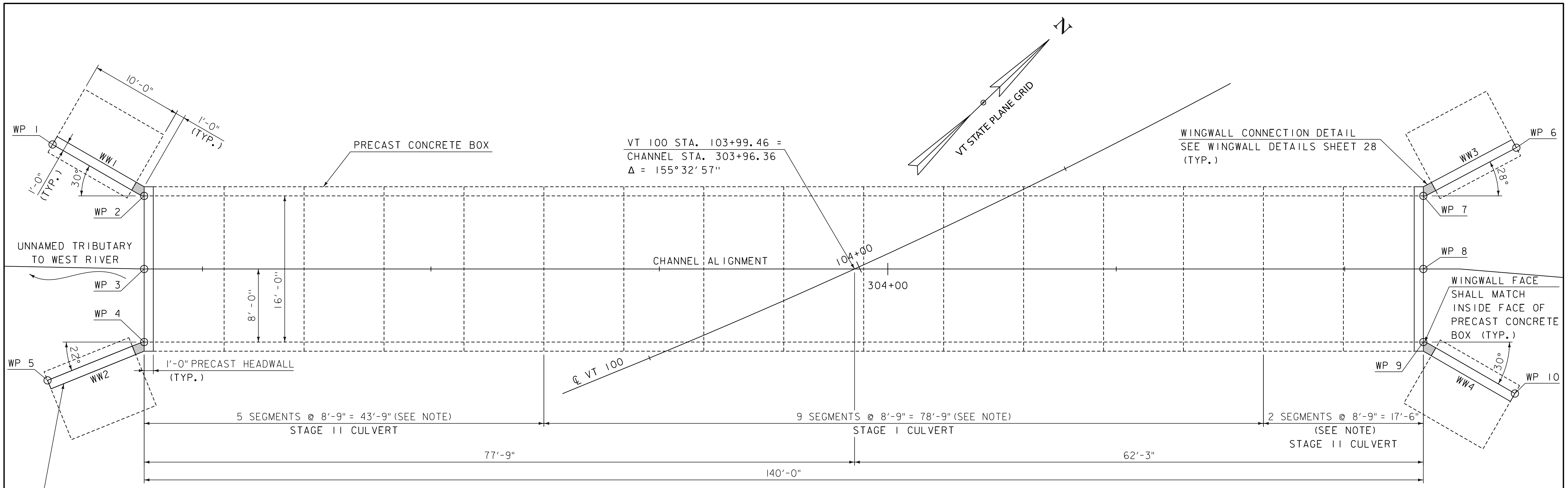

PRECAST CONCRETE STRUCTURE PLAN

SCALE = 3/16" = 1'-0"

WINGWALL CONNECTION DETAIL
SEE WINGWALL DETAILS SHEET 28
(TYP.)

WORKING POINT	NORTHING	EASTING	STATION	OFFSET
WP 1	277626.11	1563851.93	103+23.38	46.39' LT
WP 2	277629.45	1563862.94	103+30.53	37.37' LT
WP 3	277623.92	1563868.71	103+27.50	29.97' LT
WP 4	277618.38	1563874.49	103+24.47	22.57' LT
WP 5	277607.84	1563870.20	103+13.09	22.69' LT
WP 6	277741.54	1563963.03	104+68.95	21.34' RT
WP 7	277730.54	1563959.80	104+57.81	20.92' RT
WP 8	277725.00	1563965.57	104+54.07	27.92' RT
WP 9	277719.47	1563971.35	104+50.39	34.94' RT
WP 10	277722.81	1563982.35	104+56.16	44.70' RT

NOTE:
CULVERT SEGMENTS SHOWN ARE CONCEPTUAL. ACTUAL SEGMENT LENGTHS MAY VARY FROM THAT SHOWN BASED ON CONTRACTOR MEANS AND METHODS AND PRECASTER'S DESIGN.

SHEET MEMBRANE WATERPROOFING (INCIDENTAL TO ITEM 540.1000), MEETING THE REQUIREMENTS OF SUBSECTION 726.08 (c), PLACED OVER CENTER OF JOINT, MINIMUM OF 1'-0" FROM CENTER ON EACH SIDE. ANY OVERLAPPING OF THE MEMBRANE SHALL OVERLAP A MINIMUM OF 1'-0". PROTECTION BOARD MEETING THE REQUIREMENTS OF SUBSECTION 735.01 PLACED OVER MEMBRANE.

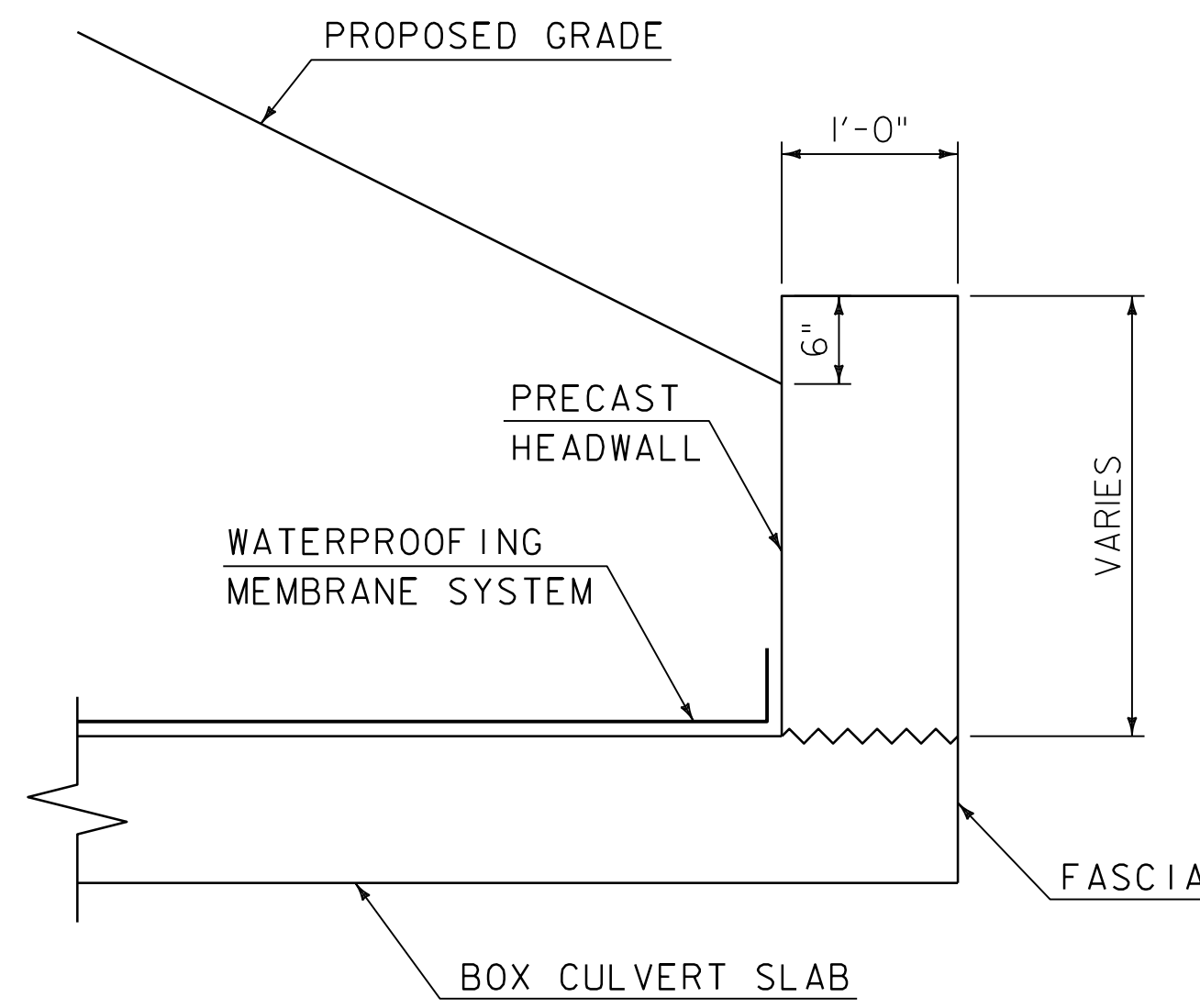

HEADWALL TYPICAL SECTION

SCALE = 1" = 1'-0"

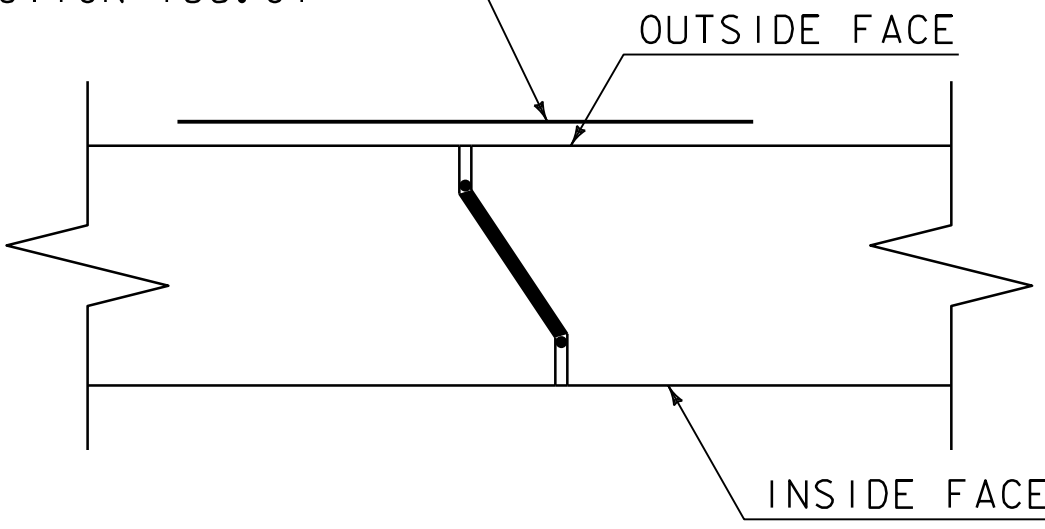

JOINT DETAIL

SCALE = 1/2" = 1'-0"

NOTE:
JOINT IN BOX CULVERT WALL SHOWN. JOINT IN BOX CULVERT SLAB SIMILAR, EXCEPT WATERPROOFING MEMBRANE SYSTEM SHALL COVER THE ENTIRE TOP OF THE SLAB.

ADDENDUM	REVISION	DATE	DESCRIPTION	BY
2	1	06-09-2026	ADDED JOINT DETAIL NOTE	CSB

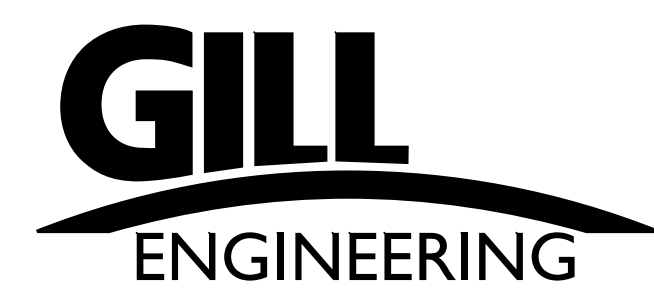

PROJECT NAME:	WESTON	PLOT DATE:	5-JUN-2026
PROJECT NUMBER:	ER P23-I(230)	DRAWN BY:	C.BURNER
FILE NAME:	z24b003culvert+det.dgn	CHECKED BY:	L.CECCHI
PROJECT LEADER:	A.SPERA	SHEET	27 OF 40
DESIGNED BY:	C.BURNER		
CULVERT DETAILS			